

# 2017 RESNA Conference

June 27-29, 2017

HILTON NEW ORLEANS RIVERSIDE - LEVEL 2 - CHURCHILL

24 - 10' X 10 Booths  
 2 - 10' X 20' Booths  
 1 - 20' x 20' Booth  
 7 - 6' Table Top Spaces

60 - 4' x 8' Poster Board SIDES

Food & Beverage Areas

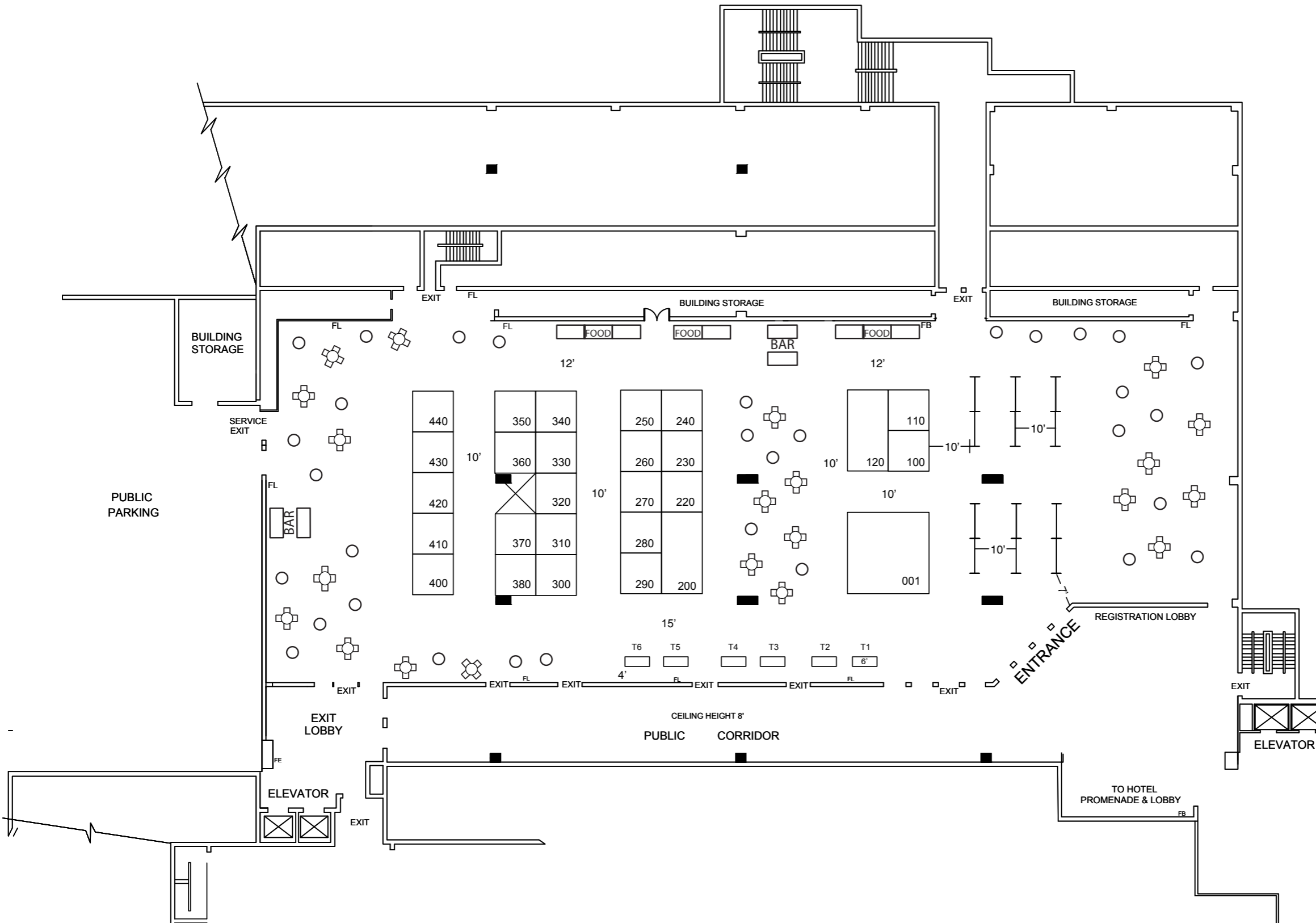

## FREEMAN

**Disclaimer** - Every effort has been made to ensure the accuracy of all information contained on this floor plan. However, no warranties, either expressed or implied, are made with respect to this floor plan. If the location of building columns, utilities or other architectural components of the facility is a consideration in the construction or usage of an exhibit, it is the sole responsibility of the exhibitor to physically inspect the facility to verify all dimension and locations.  
 © Copyright 2007, Freeman Co. All rights reserved.

**Confidential and Proprietary** - the information contained herein is the proprietary information of Freeman and by accessing the information, the recipient agrees to keep the information confidential and not disclose it to any third party without the prior consent of Freeman. Recipient also agrees to only use the information for its internal evaluation purposes and for no other purpose, without the prior consent of Freeman.

## Sponsor and Exhibitor Booths

**National Mobility Equipment Dealers Association (NMEDA)**  
Booth #001  
www.nmeda.com

**Taylor & Francis**  
Booth #250  
www.tandfonline.com

**National Coalition for Assistive and Rehab Technology (NCART)**  
Booth #310  
www.ncart.us

**Penn State University, RERC on AAC**  
Booth #410  
rerc-aac.org

**Partnership on Employment & Accessible Technology (PEAT)**  
Booth #100  
www.peatworks.org

**Positional Therapy Pillows**  
Booth #260  
www.comfyliiftbed.com

**American Congress of Rehabilitation Medicine (ACRM)**  
Booth #320  
www.acrm.org

**University of Pittsburgh, RERC on ICT Access**  
Booth #420  
www.rercict.pitt.edu

**RESNA**  
Booth #110  
www.resna.org

**Prehensile Technologies**  
Booth #270  
www.prehensiletechnologies.com

**George Mason University**  
Booth #330  
<https://gse.gmu.edu/assistive-technology>

**University of Colorado Assistive Technology Partners**  
Booth #430  
www.assistivetechologypartners.org

**Control Bionics**  
Booth #120  
www.controlbionics.com

**OrCam**  
Booth #280  
www.orcam.com

**AGE-WELL**  
Booth #340  
<http://www.techsage.gatech.edu/> and <http://www.agesage.ca/>

**University of Alabama at Birmingham**  
Booth #440  
www.rectech.org

**Quantum Rehab/Pride Mobility**  
Booth #200  
www.quantumrehab.com

**LS&S**  
Booth #290  
www.lssproducts.com

**Otto Trading Inc.**  
Booth # 370  
www.unimedmassager.com

**Sunrise Medical**  
Booth #220  
www.sunrisemedical.com

**Permobil, Inc.**  
Booth #230  
www.permobilus.com

**Southwest ADA Center**  
Booth #380  
www.southwestada.org

**Tobii Dynavox**  
Booth #240  
www.tobiidynavox.com

**KY AgrAbility**  
Booth #300  
www.uky.edu

**Smith-Kettlewell Eye Research Institute**  
Booth #400  
www.ski.org

## Tabletops

**BlueSky Designs**  
Tabletop #1  
www.mountnmover.com

**LS&S**  
Tabletop #2  
www.lssproducts.com

**National AgrAbility Project**  
Tabletop #3  
www.agrability.org

**LS&S**  
Tabletop #4  
www.lssproducts.com

**Perceptive Devices LLC**  
Tabletop #5  
www.percept-d.com